



## Mildenhall, Bury St. Edmunds, Suffolk, IP28 7PF

**Rent - Asking Price £210,000      Deposit -**

Located in the heart of Mildenhall town centre, this well-presented end-of-terrace townhouse offers generous and versatile accommodation arranged over three floors, all within easy walking distance of local shops, amenities and services.

The property boasts spacious living throughout, beginning with a modern kitchen/diner ideal for everyday family life and entertaining, complemented by a bright and spacious lounge. A convenient downstairs WC completes the

- END OF TERRACE TOWNHOUSE
- WALKING DISTANCE TO LOCAL AMENITIES
- MODERN KITCHEN/DINER
- DOWNSTAIRS WC
- FULLY ENCLOSED REAR GARDEN
- TOWN CENTRE LOCATION IN MILDENHALL
- SPACIOUS ACCOMMODATION OVER THREE FLOORS
- GENEROUS LOUNGE
- THREE DOUBLE BEDROOMS
- GARAGE AND OFF-ROAD PARKING



Council Tax Band: - EPC Rating: D 59

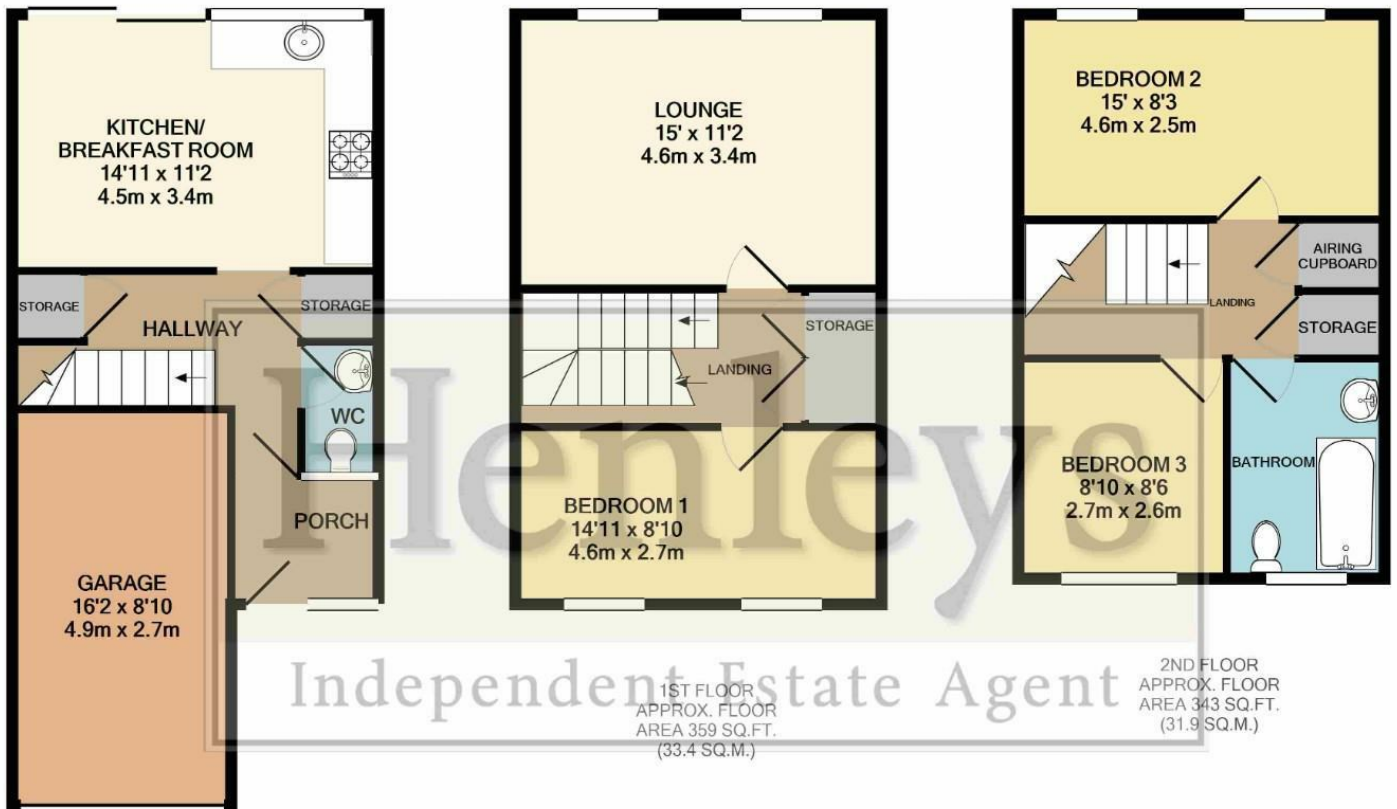

GROUND FLOOR  
APPROX. FLOOR  
AREA 432 SQ.FT.  
(40.2 SQ.M.)

TOTAL APPROX. FLOOR AREA 1135 SQ.FT. (105.4 SQ.M.)

Whilst every attempt has been made to ensure the accuracy of the floor plan contained here, measurements of doors, windows, rooms and any other items are approximate and no responsibility is taken for any error, omission, or mis-statement. This plan is for illustrative purposes only and should be used as such by any prospective purchaser. The services, systems and appliances shown have not been tested and no guarantee as to their operability or efficiency can be given  
Made with Metropix ©2020

